

**1 Bedroom 1 Bath**  
**first floor**

**871 Square Feet**

**Starting at \$890**

## INTERIOR FEATURES

- **1 AND 2 BEDROOM TOWNHOMES WITH DIRECT ACCESS ONE CAR GARAGE**
- **SECOND FLOOR APARTMENTS FEATURE GROUND-LEVEL ENTRY WITH INTERIOR STAIRWELL**
- **FULLY APPOINTED GOURMET KITCHEN**
- **UTILITY ROOM WITH FULL-SIZE WASHER AND DRYER**
- **ROMAN TUB**
- **WALK-IN CLOSET WITH BUILT-IN SHELVING**
- **CERAMIC TILE FLOORING IN THE KITCHEN, BATH AND ENTRY AREAS**

## RECREATIONAL FEATURES

- **AUTOMATED GATE ACCESS**
- **GRAND CLUBHOUSE**
- **FITNESS CENTER WITH NAUTILUS EQUIPMENT**
- **LARGE RESORT-STYLE POOL**
- **RELAXING SPA**
- **BARBECUE AREA WITH PICNIC TABLES**
- **SPORTS COURT**
- **LIGHTED TENNIS COURT**

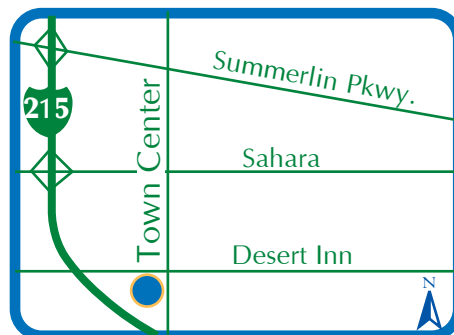
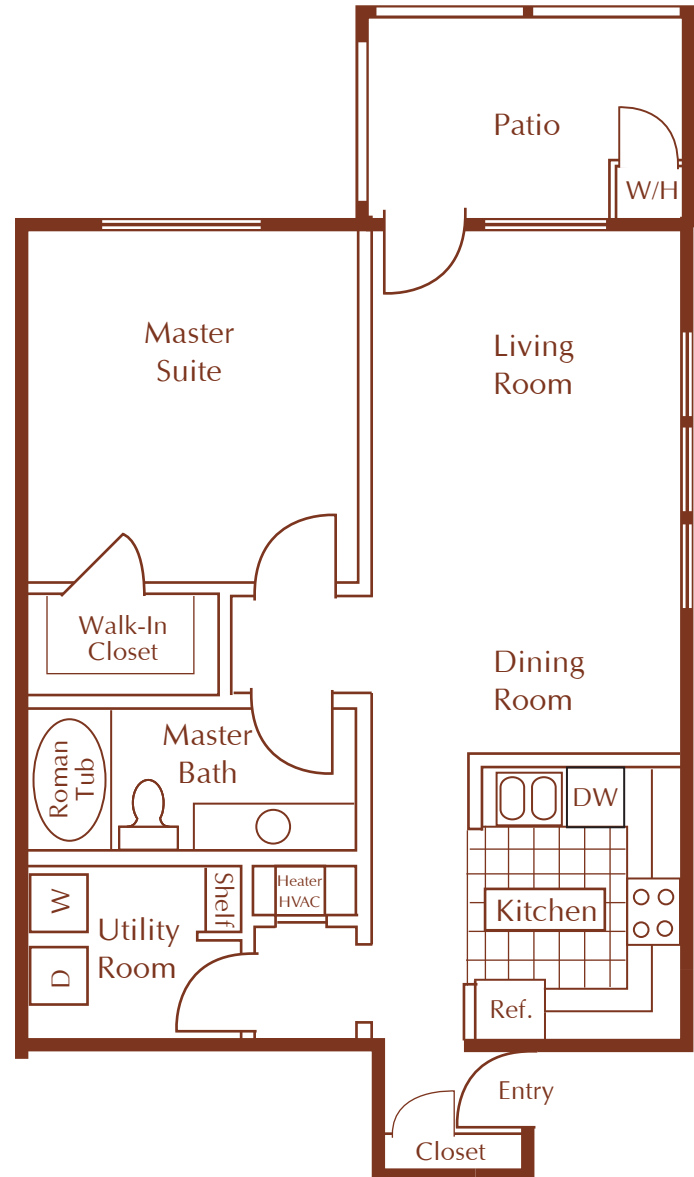

PRICES SUBJECT TO CHANGE WITHOUT NOTICE

**MON-FRI: 8AM-6PM**  
**SAT & SUN: 8AM-6PM**

**MORNINGSTAR**  
**3355 SOUTH TOWN CENTER DRIVE**  
**LAS VEGAS, NEVADA 89135**

**PHONE: 702.451.0409**  
**FAX: 702.451.0462**  
**WWW.MORNINGSTARAPARTMENTS.COM**